

STEELHEAD™ 260

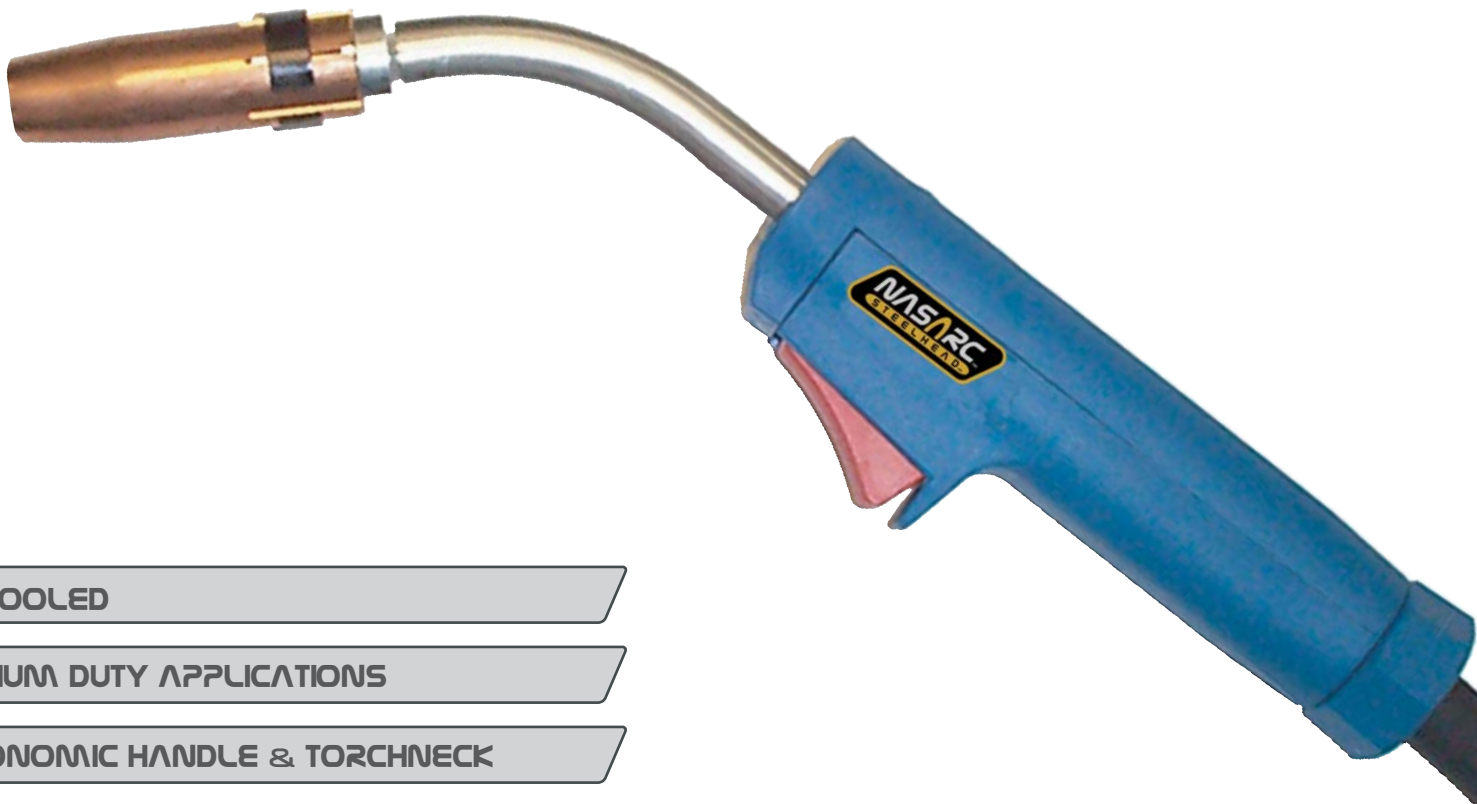

AIR COOLED

MEDIUM DUTY APPLICATIONS

ERGONOMIC HANDLE & TORCHNECK

PRODUCT DESIGNATION

Steelhead 260 10' (.035)	TAS261035-1E (Euro)*
Steelhead 260 12' (.035)	TAS261235-1E (Euro)*
Steelhead 260 15' (.035)	TAS261535-1E (Euro)*

* For other power pins, please designate with the following code: 1M(Miller), 1L (Lincoln), 2L(Lincoln 10).

TECHNICAL DATA

Steelhead 260	60% Duty Cycle	w/CO2 Gas
260 AMPERES	60% Duty Cycle	w/ Mixed Gas
225 AMPERES		
Wire Sizes: 0.030-0.045 inches (0.8-1.2mm)		

Duty rating is based on a 10-minute cycle under NEMA arc welding section standard 11-6-1975

Complies with IEC 60974-7

United States:
Nasarc Industries, Inc.
103 W. College Avenue, Suite 200
Appleton, Wisconsin 54911
Tel: (888) 844-0991 Fax: (920) 380-2399

Canada:
Nasarc Technologies, Inc.
785 Bridge ST W, Unit 1 & 2
Waterloo, Ontario, Canada N2V 2K1
Tel: (519) 747-0336 Fax: (519) 886-9022

Adapter Kits

Item #	Description	Part #
P1	Torch Power Pin-Euro(A)	TPP010001
P2	Torch Power Pin-Lincoln	TPP010002
P3	Torch Power Pin-Lincoln 10	TPP010003
P4	Torch Power Pin-Miller	TPP010004
P5	Torch Power Pin-Tweco	TPP010005

Consumables - Front End

Item #	Description	Part #
C6	Contact Tip C6 .030 (0.8mm)	TCC010630
C6	Contact Tip C6 .035 (0.9mm)	TCC010635
C6	Contact Tip C6 .045 (1.2mm)	TCC010645
T6	Tip Holder, C26	TCT010604
N1	Nozzle, Standard 26	TCN010014
N2	Nozzle, Tapered 26	TCN010015
N3	Nozzle, Straight 26	TCN010016
N4	Nozzle, Spot 26	TCN010017

Parts

Item #	Description	Part #
G1	Torch Neck, S200	TPG011200
G2	Spring, Retaining S20	TPG010001
H1	Handle, S20	TPH011020
H2	Trigger, Red, Std.	TPH010001
A1	Nut, Hex M10X1	TPA010001
A2	Trigger Wire Lug, Female	TPA010002
A3	Trigger Wire Conn., Male	TPA010003
A4	Cable Assembly, 25QMM (10')	TPA012510
A4	Cable Assembly, 25QMM (12')	TPA012512
A4	Cable Assembly, 25QMM (15')	TPA012515
S1	Strain Relief, 16-50QMM	TPS011650
S2	Handle, Back-End	TPS010120
S3	Screw, M4X6	TPS010046
L1	Liner, .030-.035 (0.8-0.9mm) 10'	TPL010110
L1	Liner, .030-.035 (0.8-0.9mm) 12'	TPL010112
L1	Liner, .030-.035 (0.8-0.9mm) 15'	TPL010115
L1	Liner, .035-.045 (0.9-1.2mm) 10'	TPL010210
L1	Liner, .035-.045 (0.9-1.2mm) 12'	TPL010212
L1	Liner, .035-.045 (0.9-1.2mm) 15'	TPL010215
L2	Liner Collet .030-.035 (0.8-0.9mm)	TPL013035
L2	Liner Collet .035-.045 (0.9-1.2mm)	TPL013545

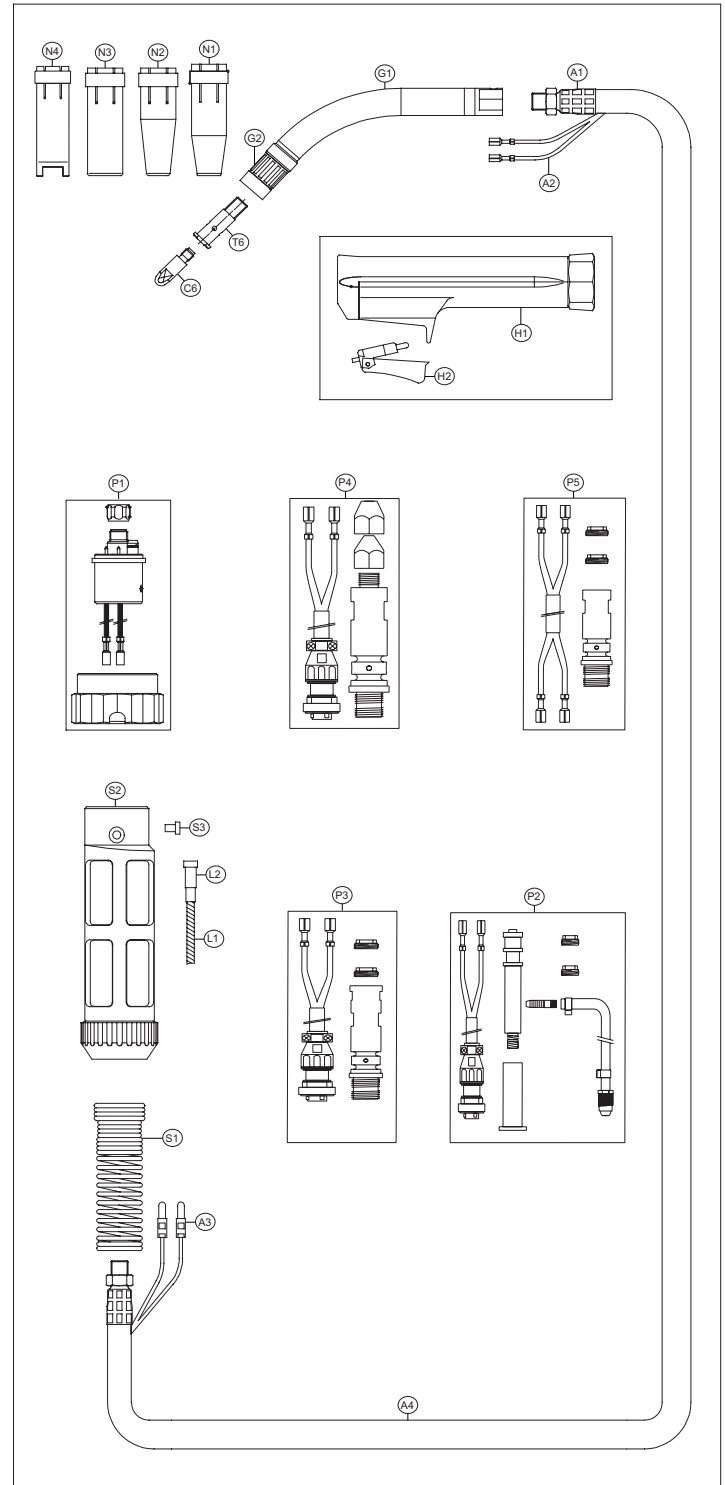

For more information, contact your local Nasarc distributor.