



**Adapter Kits**

Item #	Description	Part #
P1	Torch Power Pin-Euro(W)	TPP010007
P2	Torch Power Pin-Lincoln	TPP010002
P3	Torch Power Pin-Lincoln 10	TPP010003
P4	Torch Power Pin-Miller	TPP010004
P5	Torch Power Pin-Tweco	TPP010005

**Consumables - Front End**

Item #	Description	Part #
C8	Contact Tip C8 .030 (0.8mm)	TCC010830
C8	Contact Tip C8 .035 (0.9mm)	TCC010835
C8	Contact Tip C8 .045 (1.2mm)	TCC010845
C8	Contact Tip C8 .052 (1.4mm)	TCC010852
C8	Contact Tip C8 .062 (1.6mm)	TCC010862
T8	Tip Holder, 1" (25mm) C8	TCT010802
T8	Tip Holder, 1 1/8" (29mm) C8	TCT010803
D1	Diffusor, Brown	TCD010005
D1	Diffusor, White	TCD010006
D1	Diffusor, Ceramic 50	TCD010007
D1	Diffusor, Black	TCD010008
N1	Nozzle, Standard 5/8" (16mm)	TCN010007
N1	Nozzle, Heavy Duty 5/8" (16mm)	TCN010008
N2	Nozzle, Tapered 9/16" (14mm)	TCN010009
N3	Nozzle, Straight 3/4" (19mm)	TCN010010
N5	Nozzle, Tapered 1/2" (12mm)	TCN010012

**Parts**

Item #	Description	Part #
G1	Torch Neck, Short S500W	TPG011501
G2	Torch Neck, Long S500W	TPG011502
G3	Insulating Washer S56	TPG010005
H1	Handle, Black S3-5W	TPH011035
H2	Trigger, Red, Std.	TPH010001
H3	Screw, Handle	TPH010002
A2	Trigger Wire Lug, Female	TPA010002
A3	Trigger Wire Conn, Male	TPA010003
A4	Cable Assembly, W (10')	TPA010005
A4	Cable Assembly, W (12')	TPA010006
A4	Cable Assembly, W (15')	TPA010007
A5	Fitting, Cable	TPA010008
A6	Support, Spring	TPA010009
A7	Spring	TPA010010
A8	Cable Support	TPA010011
A9	Strain Relief Assembly	TPA010012
B1	Cable Support Handle	TPA010013
S3	Screw, M4X6	TPS010046
L1	Liner, N/I .030-.035(0.8-0.9mm) 10'	TPL010410
L1	Liner, N/I .030-.035(0.8-0.9mm) 12'	TPL010412
L1	Liner, N/I .030-.035(0.8-0.9mm) 15'	TPL010415
L1	Liner, N/I .035-.045(0.9-1.2mm) 10'	TPL010510
L1	Liner, N/I .035-.045(0.9-1.2mm) 12'	TPL010512
L1	Liner, N/I .035-.045(0.9-1.2mm) 15'	TPL010515
L1	Liner, N/I .045-.062(1.2-1.6mm) 10'	TPL010610
L1	Liner, N/I .045-.062(1.2-1.6mm) 12'	TPL010612
L1	Liner, N/I .045-.062(1.2-1.6mm) 15'	TPL010615
L2	Liner Collet .030-.035 (0.8-0.9mm)	TPL013035
L2	Liner Collet .035-.045 (0.9-1.2mm)	TPL013545
L2	Liner Collet .045-.062 (1.2-1.6mm)	TPL014562

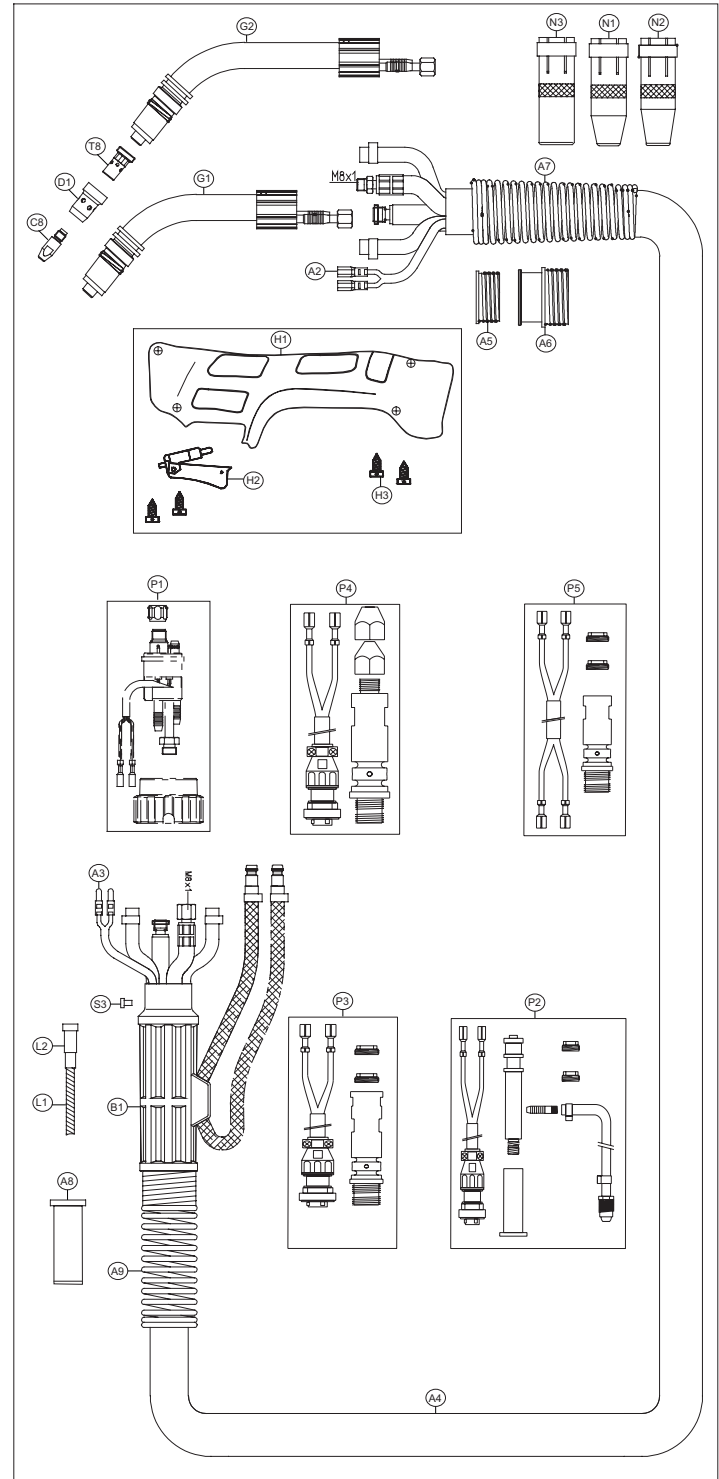

For more information, contact your local Nasarc distributor.